

- **Mobile Viewing is a function that allows a user to access, view and configure any DVR or NVR using a Smartphone or Tablet from anywhere in the world.**



Device	Application
Android Smartphone	GCMOB
Android Tablet	GCMOB HD
iPhone	ICMOB
iPad	ICMOB HD
Windows Smartphone	WCMOB
Windows Tablet	WCMOB HD



- **Once the appropriate App has been downloaded from an App Store which is 100% free, open the app:**



- The opening screen will look as follows
- To add a device (DVR/NVR) click on the main menu icon ☰ :

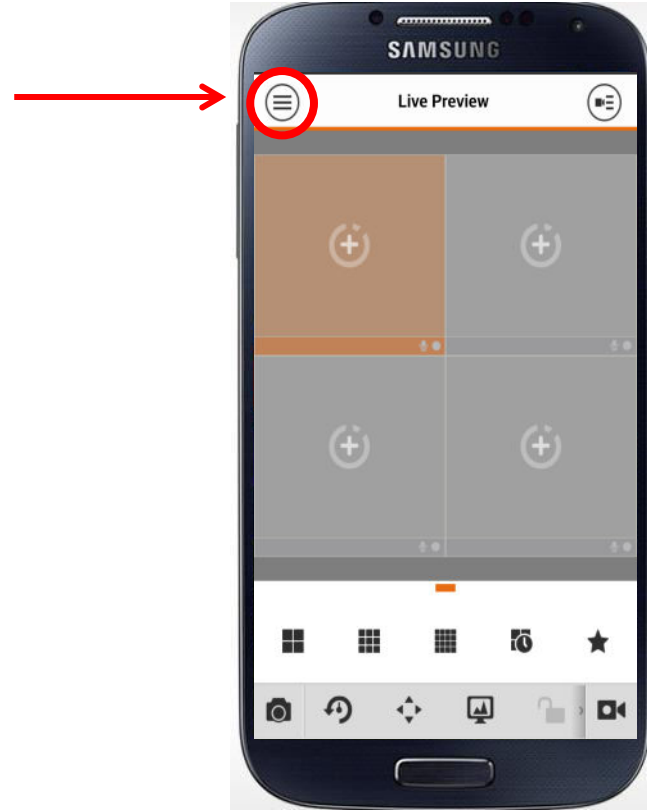

- **Click on Device Manager**  :

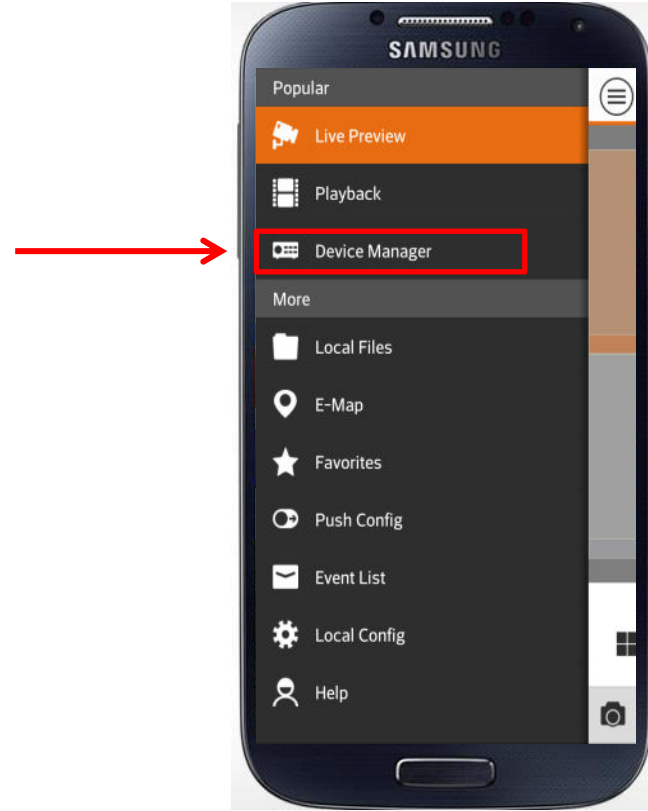

- To add a device, click the  icon:

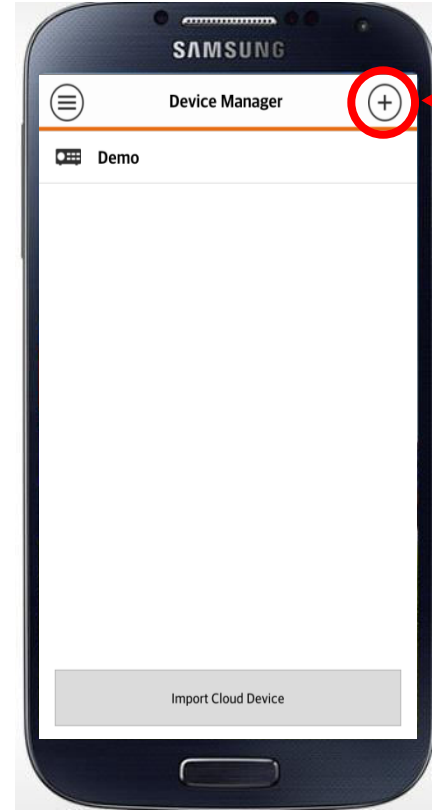

- Click on “register mode” :

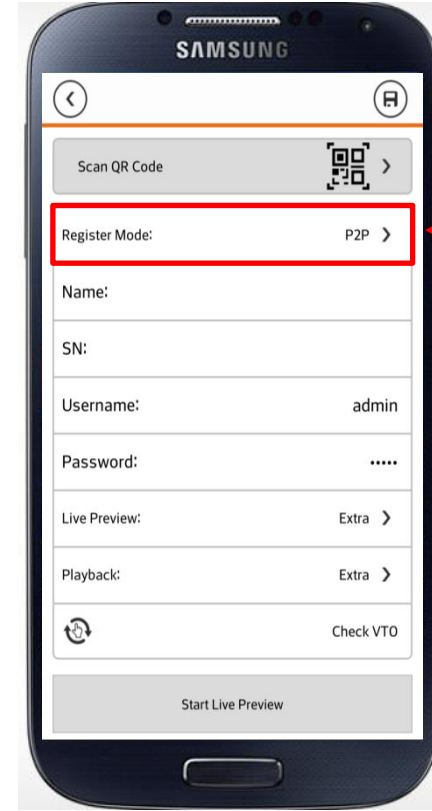

- From the pop up menu select “IP/Domain” :

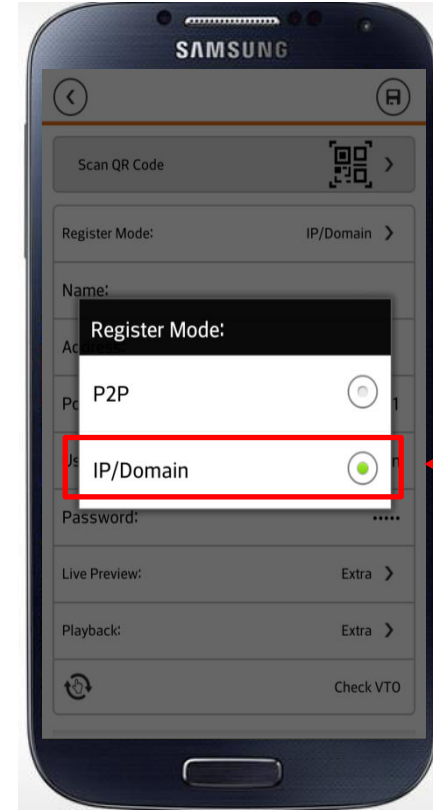

- **“Name” is user defined, it can be called anything the user wants:**

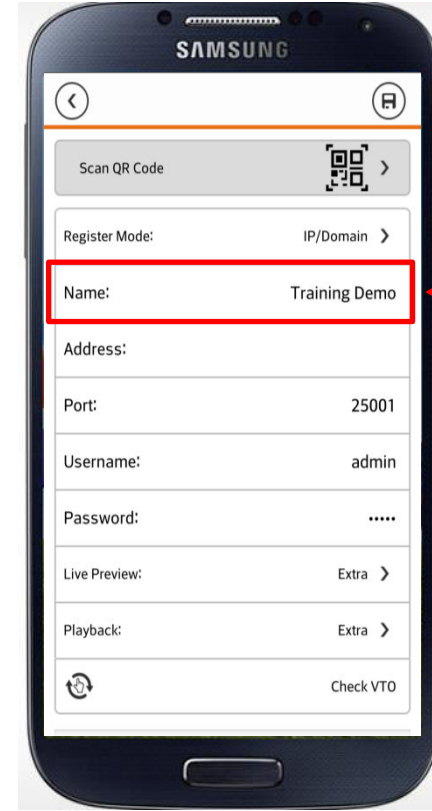

- **“Address” would be either the Internal IP Address when connected locally or the DDNS Name when connecting externally:**

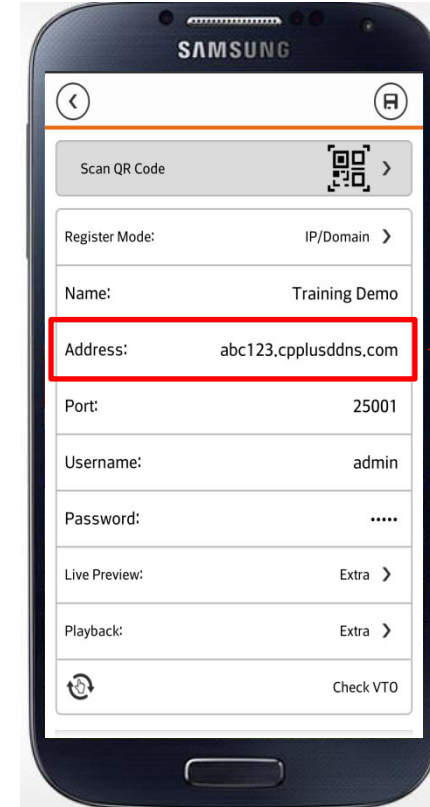

- **“Port” refers to the TCP port of the DVR. Default is 25001, if the port has changed, change this value accordingly:**

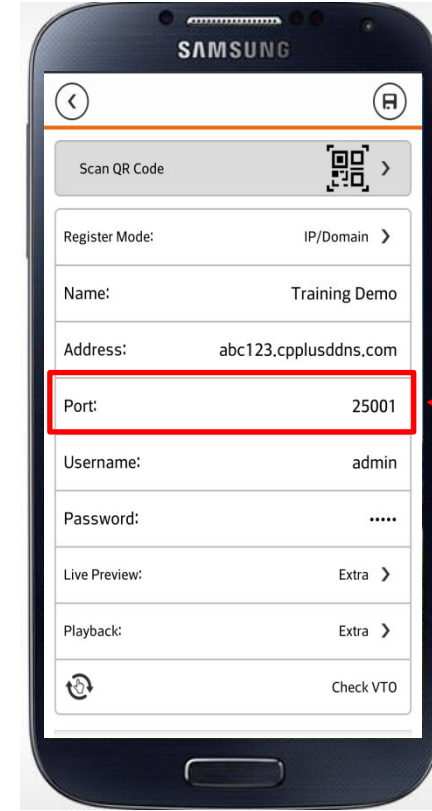

- **“Username” is the user account used to log in with, default input is “admin” :**

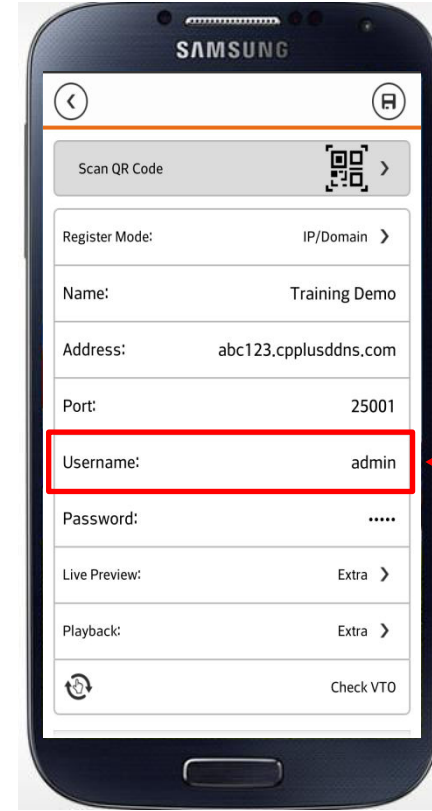

- **“Password” according to the user account used, default input is “admin”:**

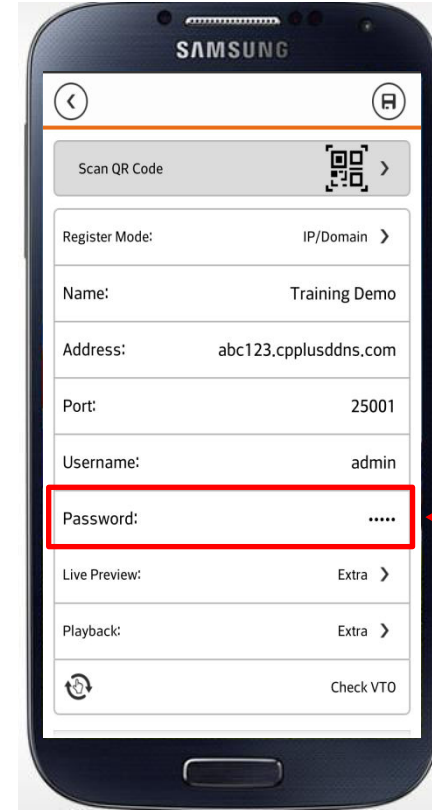

- **“Live Preview” sets the video quality of a live video feed**
- **“Playback” sets the video quality while viewing stored video feeds**
- **Both can be set to Main or Extra. It is suggested to use extra view to keep cellular data costs down as the extra view is stepped down in quality which uses less data and will operate better on a slower network:**

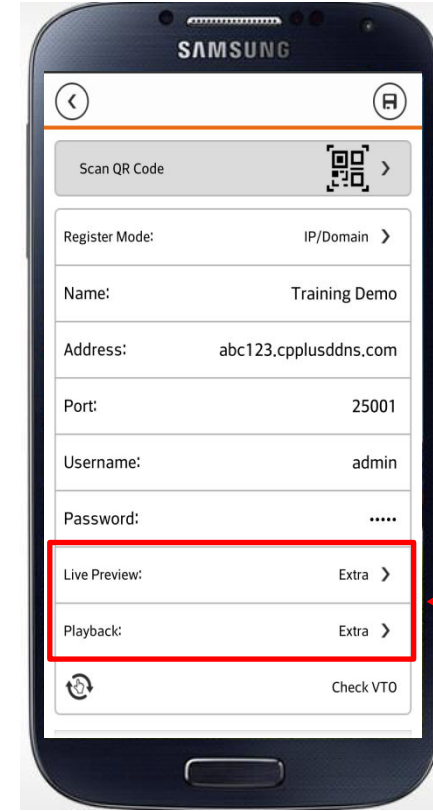

- Once the settings have been configured, click the “save” icon :

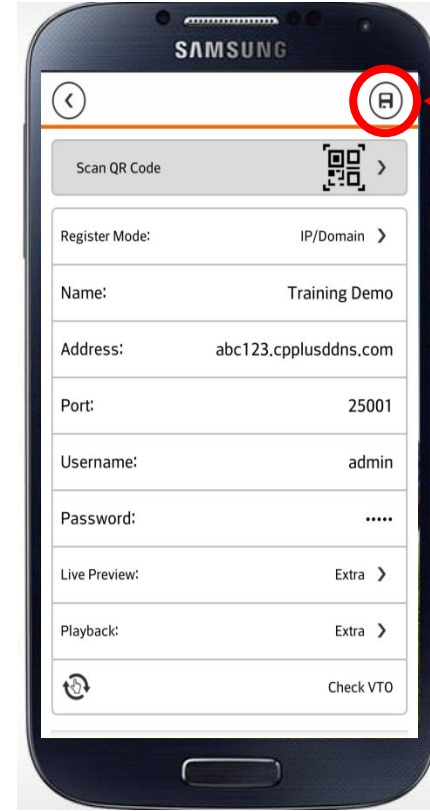

- From the Main Menu, select “Live Preview”  :

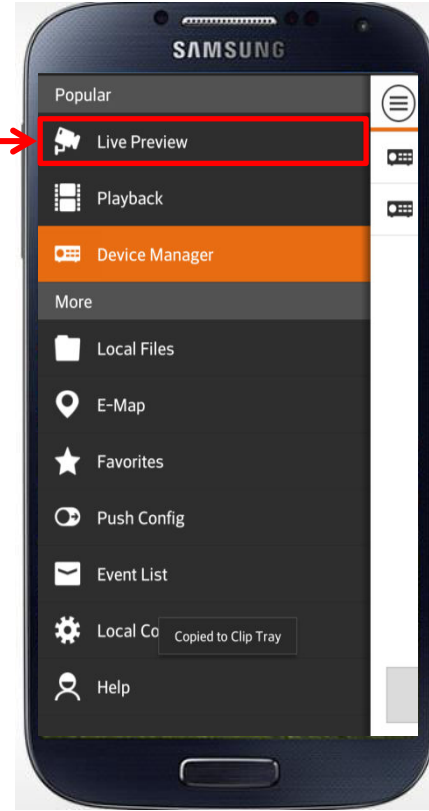

- To access a DVR, click on the  icon :

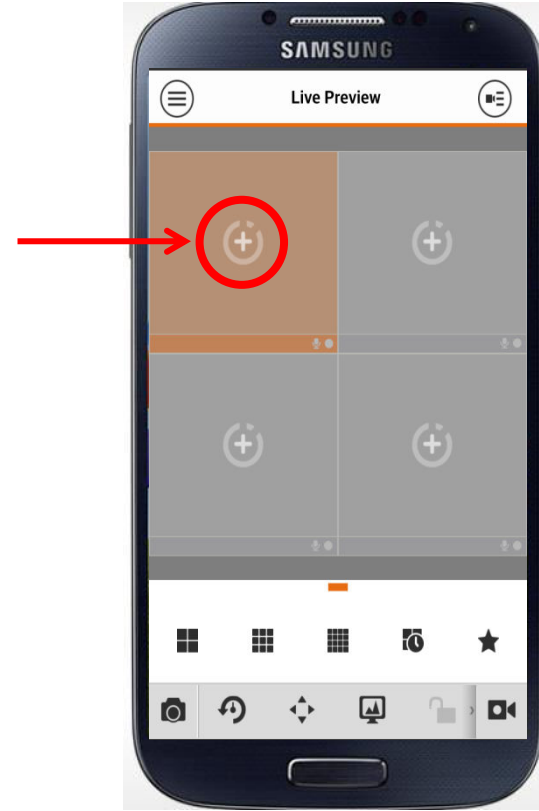

- **Drag down the device, which will show only Channel 1 for the initial log in:**

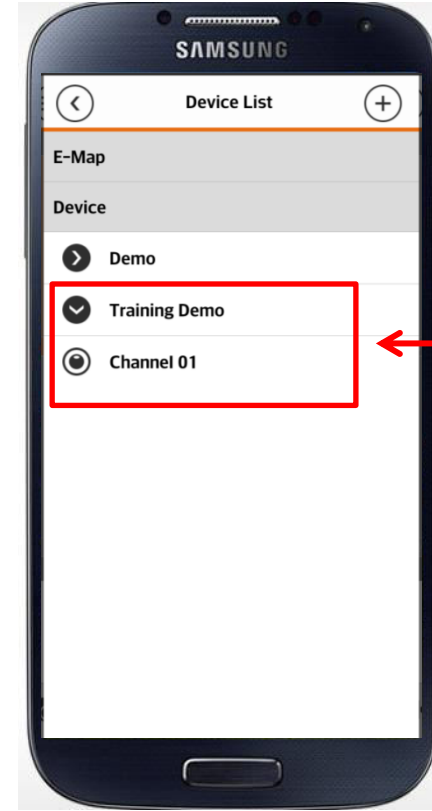

- **The App will now open Cam 1 if it is able to log in correctly:**

